

**COMPUTER UNIT TITLE REGISTER
UNDER LAND TRANSFER ACT 1952**

Search Copy



R. W. Muir
Registrar-General
of Land

Identifier **NA57C/325**
Land Registration District **North Auckland**
Date Issued 28 June 1985

Prior References

NA54D/1451 NA54D/1452 NA54D/1453

Supplementary Record Sheet
NA57C/326

Estate Stratum in Freehold

Legal Description Unit N and Accessory Unit 28-30
Deposited Plan 104005

Proprietors

Expedio Limited

The above estates are subject to the reservations, restrictions, encumbrances, liens and interests noted below and on the relevant unit plan and supplementary record sheet

446708.13 Encumbrance to The Manukau City Council - 9.2.1977 at 11.37 am

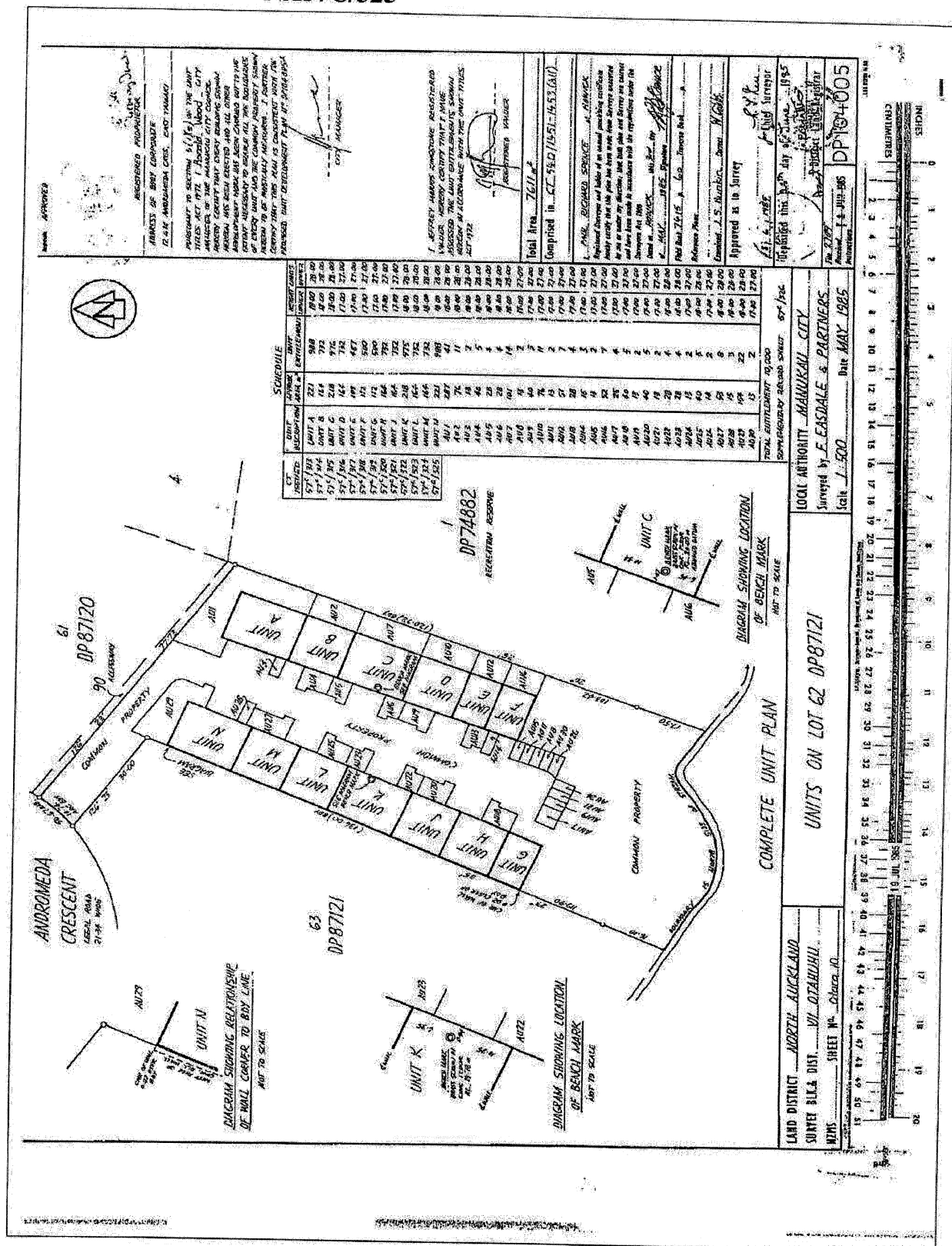

Identifier

NA57C/325

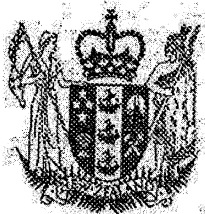

**SUPPLEMENTARY RECORD SHEET
UNDER UNIT TITLES ACT 1972**

Search Copy

Identifier

NA57C/326

Land Registration District

North Auckland

Date Issued

06 December 1984

Plan Number

DP 104005

Subdivision of

Lot 62 Deposited Plan 87121

Unit Titles Issued

NA57C/313	NA57C/314	NA57C/315	NA57C/316
NA57C/317	NA57C/318	NA57C/319	NA57C/320
NA57C/321	NA57C/322	NA57C/323	NA57C/324
NA57C/325			

Interests

OWNERSHIP OF COMMON PROPERTY

Pursuant to Section 47 Unit Titles Act 2010 -

(a) the body corporate owns the common property and

(b) the owners of all the units are beneficially entitled to the common property as tenants in common in shares proportional to the ownership interest (or proposed ownership interest) in respect of their respective units.

The above memorial has been added to Supplementary Record Sheets issued under the Unit Titles Act 1972 to give effect to Section 47 of the Unit Titles Act 2010.

Fencing Agreement in Transfer 129874

B366166.1 Notice of Change of Rules - 21.12.1984 at 9.05 am

B813173.1 Notice of Change of Rules of the Body Corporate - 8.4.1988 at 11.35 am

6441399.1 Change of address of the Body Corporate - 1.6.2005 at 9:00 am

9235520.1 Notice of change of body corporate operational rules pursuant to Section 106 Unit Titles Act 2010 - 12.11.2012 at 3:24 pm