

Approvals THE DIRECTORS OF MICHAEL RICHARD WOOD LTD.

M.R. WOOD Registered Owners

Pursuant to Section 5(1)(g) of the Unit Titles Act 1972 I Anthony Joseph Macdonald, Principal Administrative Officer of the Auckland City Council hereby certify that every building shown on this plan has been erected and all other development work has been carried out to the extent necessary to enable all the boundaries of every unit and the common property shown on the plan to be physically measured. I further certify that the said plan is consistent with the proposed unit development plan number UP 178171 A

Dated this 17th day of January 1997

Principal Administrative Officer

I Wayne Donald Godkin of Takapuna Registered Valuer hereby certify that I have assessed the unit entitlements shown herein in accordance with the Unit Titles Act 1972.

Dated this 22nd day of January 1997

Registered Valuer

Unless otherwise shown, unit boundaries are the external faces of exterior walls & structures

Address of Body Corporate:
10 BURRETT AVENUE PENROSE AUCKLAND

Origin of Levels SM3524 S05433 RL23.28
LANDS AND SURVEY DATUM 1946

EXISTING EASEMENTS		
Purpose	Shown	Created By -
WATER	(C)	D105561-1

EXISTING APPURTENANT EASEMENT		
Purpose	Created By -	
RIGHT OF WAY	B 824709-3	

Total Area 6853m²

Comprised in CT 63C/747 (Bal)

I Brian Hume Logan of Auckland Registered Surveyor and holder of an annual practicing certificate (or who may act as a registered surveyor pursuant to section 25 of the Survey Act 1986) hereby certify that this plan has been made from surveys executed by me or under my directions, that both plan and survey are correct and have been made in accordance with the Survey Regulations 1972 or any regulations made in substitution thereof.

Dated at Auckland this 20th day of June 1997

Field Book p. Traverse Book p.

Reference Plans

Examined Ken Johnson Correct W. Gibbs

Approved as to Survey 6/3/97 Chief Surveyor

Deposited this 17th day of June 1997

UP 178171

File 290
Received 12 FEB 1997
Instructions

APPROVED LM 94/4 DCSLI FORM 105

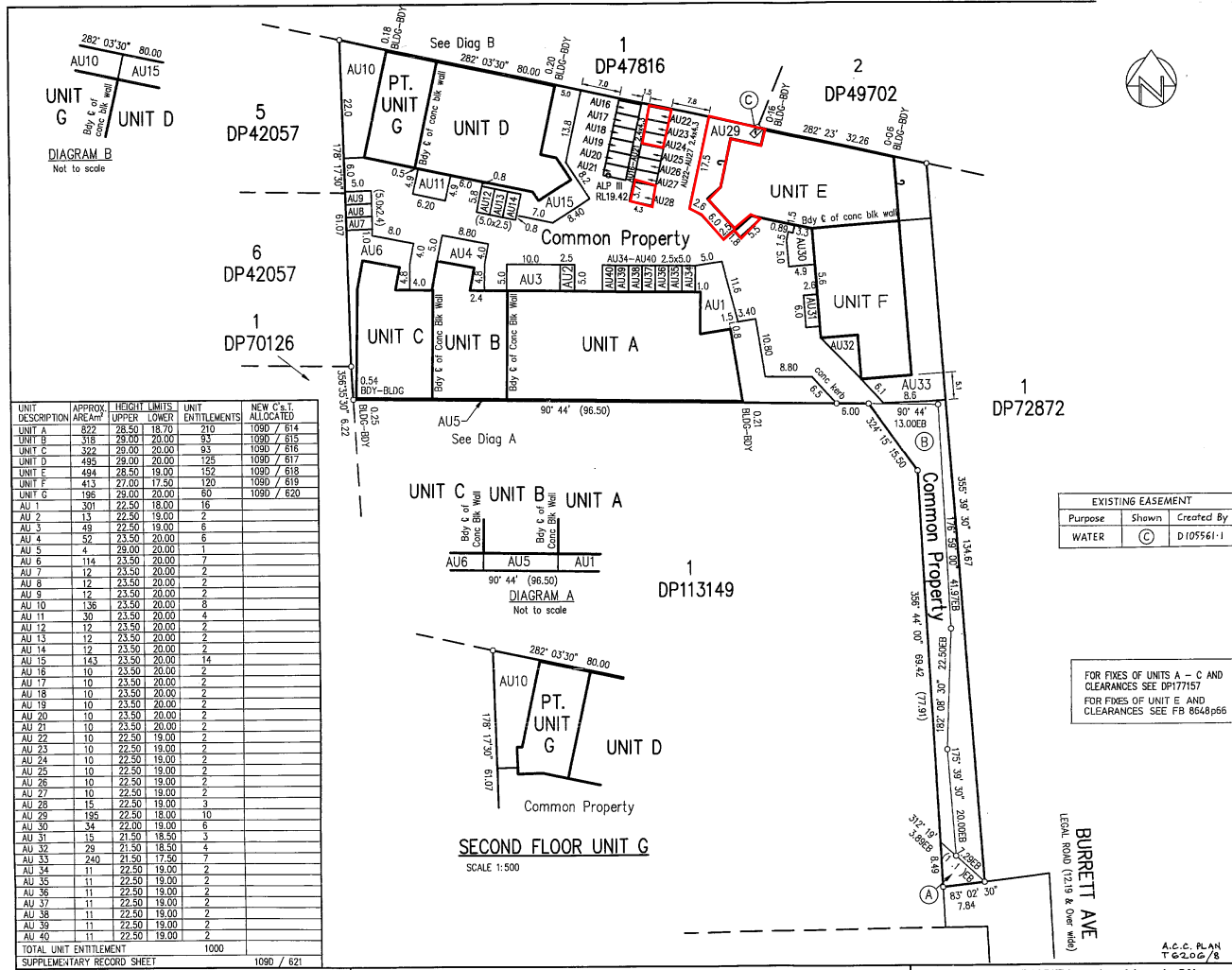

UNIT DESCRIPTION	APPROX. AREA ²	HEIGHT UPPER	LIMITS LOWER	UNIT ENTITLEMENTS	NEW C's.T. ALLOCATED
UNIT A	822	28.50	18.70	210	1090 / 614
UNIT B	316	29.00	20.00	83	1090 / 615
UNIT C	322	29.00	20.00	83	1090 / 616
UNIT D	495	29.00	20.00	125	1090 / 617
UNIT E	494	28.50	19.00	152	1090 / 618
UNIT F	413	27.00	17.50	120	1090 / 619
UNIT G	196	29.00	20.00	60	1090 / 620
AU 1	301	22.50	18.00	16	
AU 2	13	22.50	19.00	2	
AU 3	49	22.50	19.00	6	
AU 4	52	23.50	20.00	6	
AU 5	4	29.00	20.00	1	
AU 6	114	23.50	20.00	7	
AU 7	12	23.50	20.00	2	
AU 8	12	23.50	20.00	2	
AU 9	12	23.50	20.00	2	
AU 10	136	23.50	20.00	8	
AU 11	30	23.50	20.00	4	
AU 12	12	23.50	20.00	2	
AU 13	12	23.50	20.00	2	
AU 14	12	23.50	20.00	2	
AU 15	143	23.50	20.00	14	
AU 16	10	23.50	20.00	2	
AU 17	10	23.50	20.00	2	
AU 18	10	23.50	20.00	2	
AU 19	10	23.50	19.00	2	
AU 20	10	23.50	20.00	2	
AU 21	10	23.50	20.00	2	
AU 22	10	22.50	19.00	2	
AU 23	10	22.50	19.00	2	
AU 24	10	22.50	19.00	2	
AU 25	10	22.50	19.00	2	
AU 26	10	22.50	19.00	2	
AU 27	10	22.50	19.00	2	
AU 28	15	22.50	19.00	3	
AU 29	195	22.50	18.00	10	
AU 30	34	22.00	19.00	6	
AU 31	15	21.50	18.50	3	
AU 32	29	21.50	18.50	4	
AU 33	240	21.50	17.50	7	
AU 34	11	22.50	19.00	2	
AU 35	11	22.50	19.00	2	
AU 36	11	22.50	19.00	2	
AU 37	11	22.50	19.00	2	
AU 38	11	22.50	19.00	2	
AU 39	11	22.50	19.00	2	
AU 40	11	22.50	19.00	2	
TOTAL UNIT ENTITLEMENT				1000	
SUPPLEMENTARY RECORD SHEET				1090 / 621	

LAND DISTRICT North Auckland

Survey Blk. & Dist. I Otahuhu

NZMS 261 Sheet Record Map No.

COMPLETE UNIT DEVELOPMENT ON LOT 2 DP113149

TERRITORIAL AUTHORITY Auckland City

Surveyed by FEAR SURVEYING

Scale 1:500 Date DEC 1996

W.A. ROBERTSON, DIRECTOR GENERAL, SURVEYOR GENERAL, DEPARTMENT OF SURVEY AND LAND INFORMATION, NEW ZEALAND

CAD FILE BARRETT8

